

*As part of the new Pels Rijcken office will hardly receive any daylight GROUP A has introduced a multi-level library in this area.*

*[Concept, april 2007]*



## PELS RIJCKEN & DROOGLEEVER FORTUIJN, THE HAGUE

**CLIENT** Pels Rijcken & Droogleevers  
Fortuijn

**CONTACT** Marcel Abbringh

**PROJECT ADDRESS** Bezuidenhoutseweg,  
Den Haag

**FUNCTION** headoffice interior

**TYPE** interior design

**TASK** building commission

**TASK DESCRIPTION**

preliminary design, final design,  
technical design and specification,  
aesthetical monitoring

**DIMENSIONS** 13.000 m<sup>2</sup>

**STATUS** completed

**START DESIGN** April 2007

**START CONSTRUCTION** July 2009

**FINAL ACCEPTANCE** March 2010



THE MAIN ENTRANCE ON THE SECOND FLOOR DIRECTLY CONNECTS TO THE ADJACENT OFFICE PLAZA



RESTAURANT AT PELS RIJCKEN DURING THE LUNCH



SPECIFIC MEETING AREAS, LIKE THE BAR, CAN BE RECOGNISED BY A DIFFERENT, DISTINCTIVE USE OF MATERIALS AND COLOURS.



## CONCEPT

GROUP A has been responsible for the interior design for Pels Rijcken & Droogleever Fortuijn, a large law firm. The representative character of their new office should be stylish and contemporary. This has been achieved by introducing a subtle range of materials and colours, thereby distinguishing different levels of openness and hierarchy in the organisation. The new Pels Rijcken office will be located within the New Babylon building complex in The Hague, next to the Central

station. The much used main entrance on the second floor directly connects to the adjacent office plaza and station, whereas the entrance at street level will have a more symbolic value: the office street level address. GROUP A have responded to the clients wish for a single entrance by joining the two entrances with a powerful composition of a monumental stair and panorama lift. As part of the new office will hardly receive daylight we introduced a multi-level library in this area.

IN ORDER TO CREATE AN OPEN WORK ENVIRONMENT, AND TO SUBDUDE THE EFFECT OF THE DIVIDING WALLS, TRANSPARENT GLASS PARTITIONS WERE FREQUENTLY USED.



AUDITORIUM, WHICH IS USED FOR EXTERNAL AS WELL AS INTERNAL MEETINGS



## ADDITIONAL PROJECT INFORMATION



### TEAM

Folkert van Hagen, Maarten van Bremen, Philip Vencken, Adam Visser, Lolke Ket, Brigitte van der Tuin, Melis Gurbuzbalaban, Sara Rojo, Bahar Akkoclu, Ramon Wijsman, Nir Goldberg, Sandra Bsat, Andrea Giannotti, Jasper Vos, Suzanne Linders

**PROJECT MANAGER** Rietmeijer huisvestingsadviseur, Almere

**CONTRACTOR 1** Intos Interieurmakers, Haarlem  
Reception, Stairs, Italian Bar and Restaurant

**CONTRACTOR 2** Finitouch, Amersfoort  
Library and cabinets

**PHOTOGRAPHY** Roos Aldershoff, Amsterdam

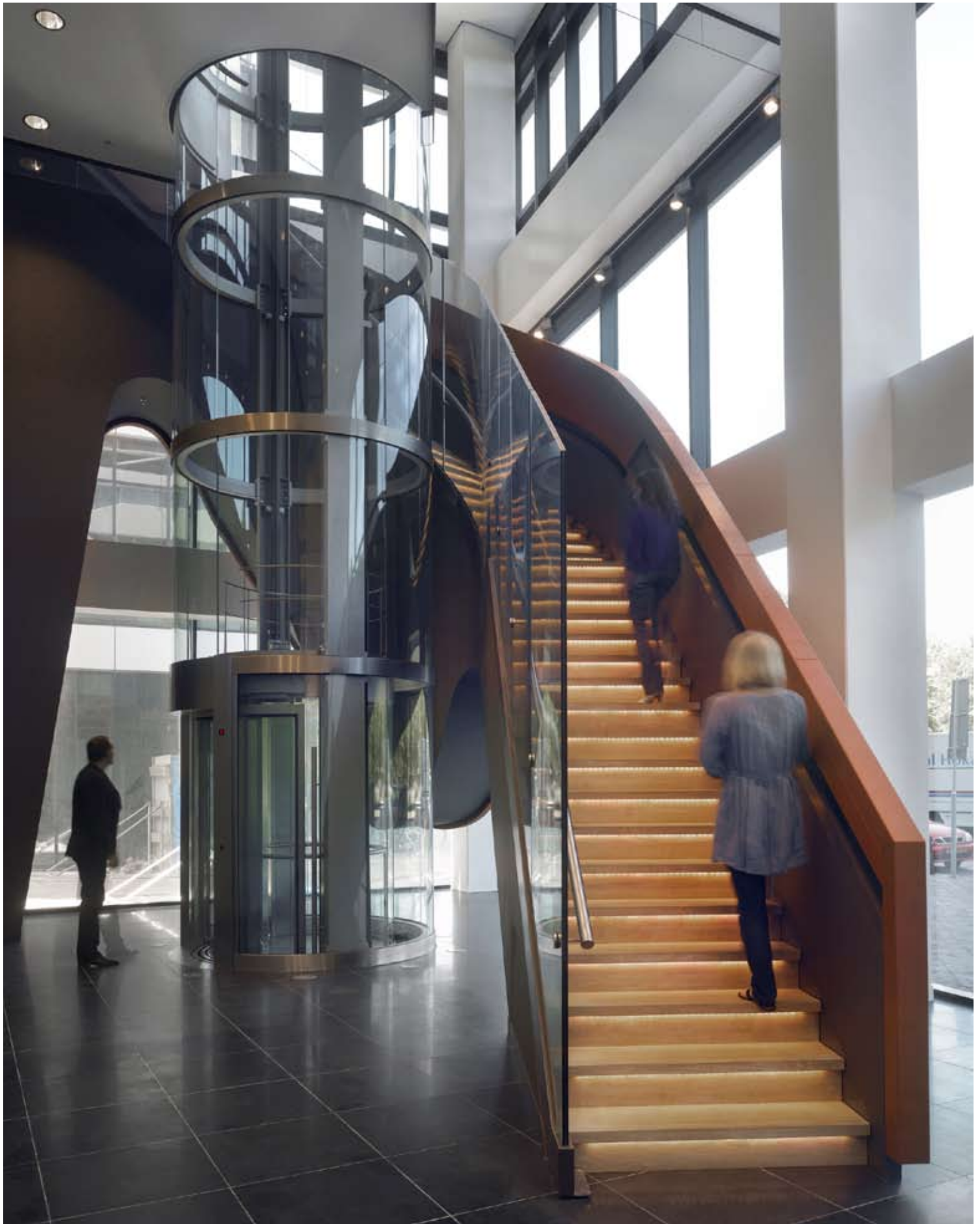

## PELS RIJCKEN & DROOGLEEVER FORTUIJN, THE HAGUE

PELGRIMSSTRAAT 3 3029 BH ROTTERDAM THE NETHERLANDS  
T +31 (0)10 244 01 93 F +31 (0)10 244 99 90  
E MAIL@GROUPA.NL WWW.GROUPA.NL



GROUP A